

# QMS2S-18-2

## DC~18GHz, SPDT

Features:  
 \* High Power  
 \* Long Operation Life

Applications:  
 \* Wireless  
 \* Transmitter  
 \* Laboratory Test  
 \* Radar

### Electrical

Frequency:	DC~18GHz
VSWR:	1.5 max.
Insertion Loss:	0.5dB max.
Isolation:	60dB min.
Average Power:	20W
Impedance:	50Ω

### Mechanical

Size <sup>*1</sup> :	37*28.5*13.2mm 1.457*1.122*0.52in
Switching Sequence:	Break before Make
Operation Life:	100000 Cycles
RF Connectors:	SMA Female
Power Supply & Control	Manual
Interface Connectors:	
Mounting:	2-Φ3mm through-hole 2-M3, depth 3mm

[1] Exclude connectors.

### Environmental

Temperature:	-30~+65°C
--------------	-----------

### Outline Drawings

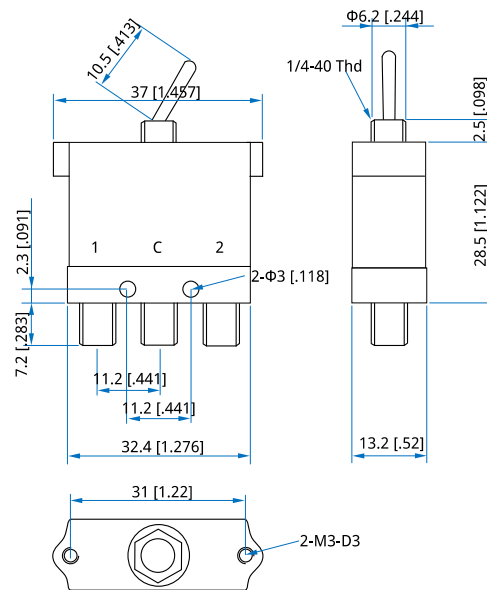

Unit: mm [in]  
 Tolerance: ±0.5mm [±0.00in]

### How To Order

#### QMS2S-18-2

Customization is available upon request.